

# CANADIAN LAKES MECOSTA COUNTY, MICHIGAN AUGUST 4, 2021 TREATMENT MAP SHEET 1

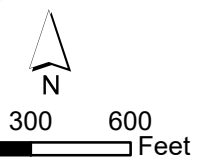

**CANADIAN LAKE**

**EAST CANADIAN LAKE**

**WEST CANADIAN LAKE**

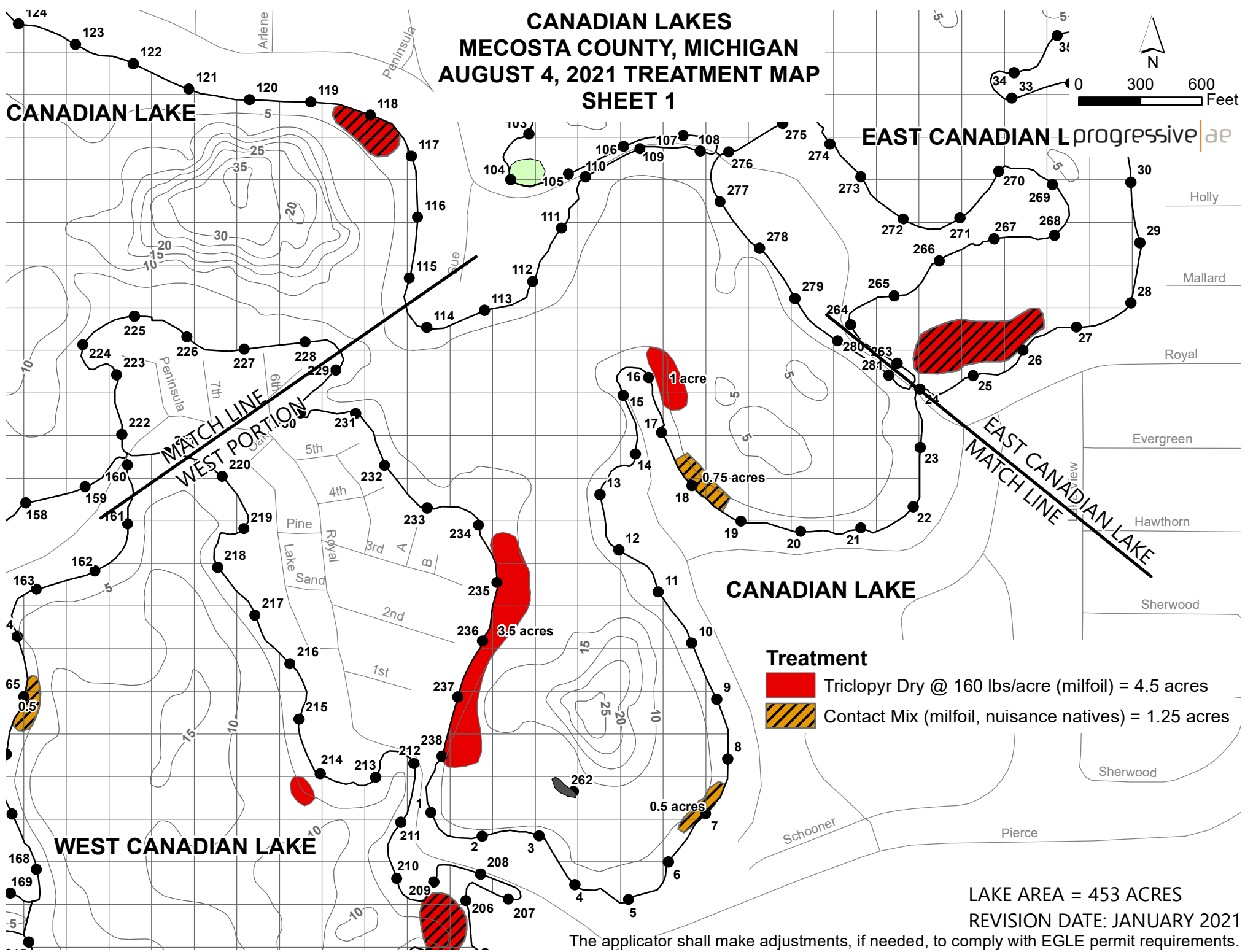

**Treatment**

- Triclopyr Dry @ 160 lbs/acre (milfoil) = 4.5 acres
- Contact Mix (milfoil, nuisance natives) = 1.25 acres



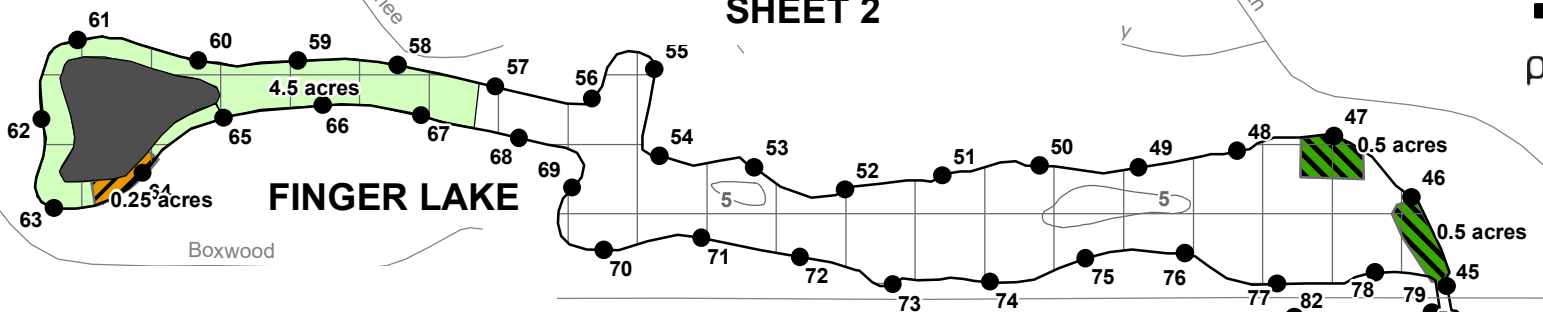
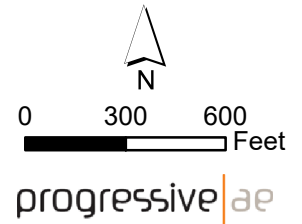

LAKE AREA = 453 ACRES  
REVISION DATE: JANUARY 2021

The applicator shall make adjustments, if needed, to comply with EGLE permit requirements.

# CANADIAN LAKES MECOSTA COUNTY, MICHIGAN AUGUST 4, 2021 TREATMENT MAP SHEET 2



## Treatment

-  Triclopyr Liquid @ 3 gal/acre (milfoil) = 3.5 acres
-  Contact Mix (milfoil, nuisance natives) = 0.25 acres
-  Chelated Copper Liquid (wild celery) = 4 acres
-  Algae treatment = 8 acres

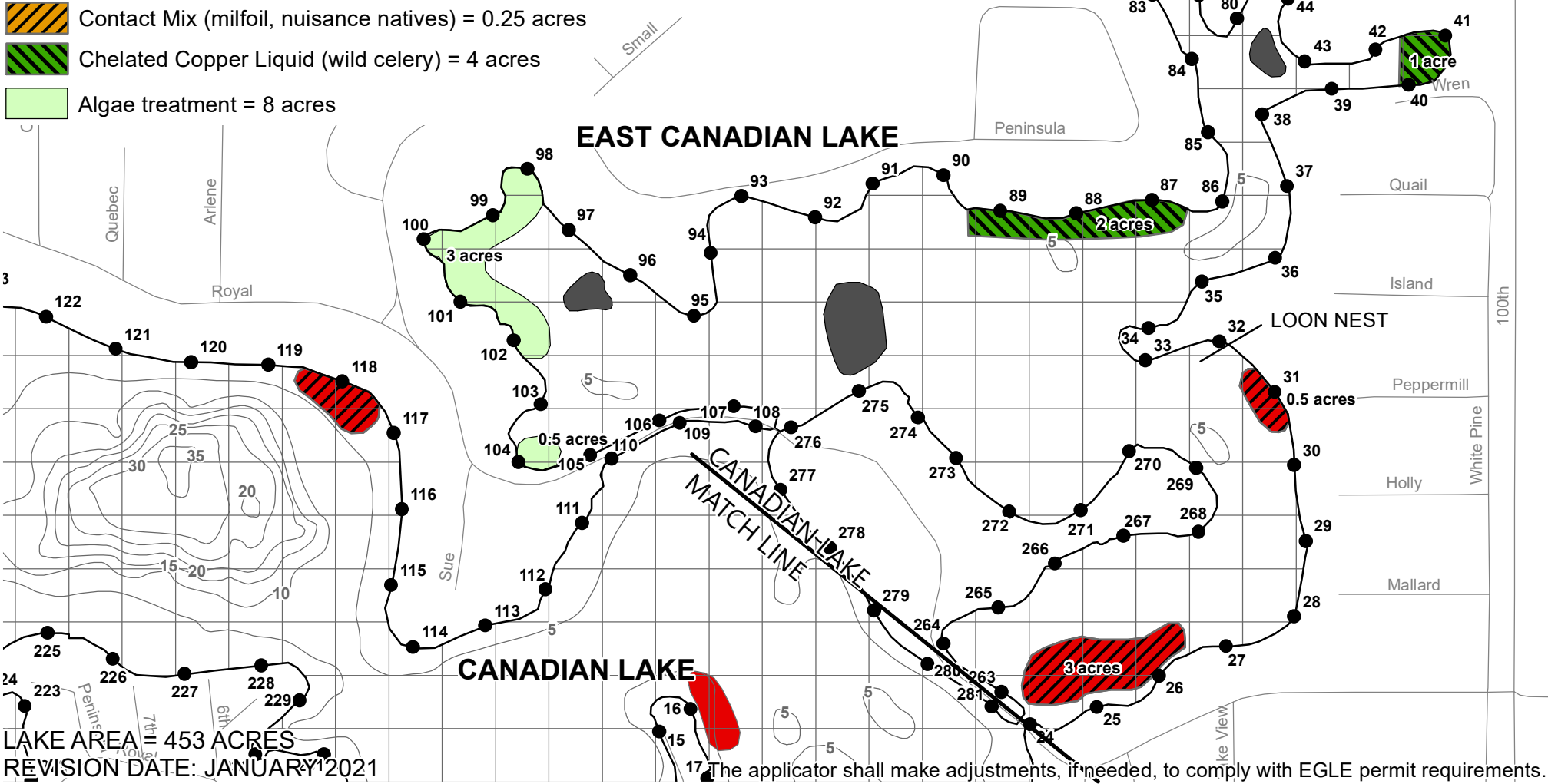

LAKE AREA: 453 ACRES  
REVISION DATE: JANUARY 2021

The applicator shall make adjustments, if needed, to comply with EGLE permit requirements.

# CANADIAN LAKES MECOSTA COUNTY, MICHIGAN AUGUST 4, 2021 TREATMENT MAP SHEET 3

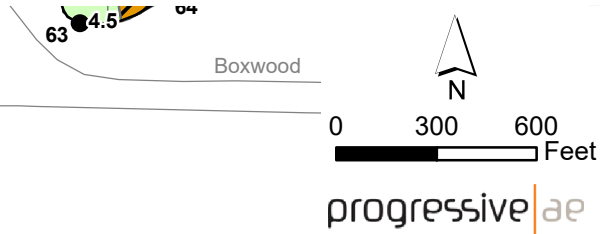

### Treatment

- Triclopyr Liquid @ 3 gal/acre (milfoil) = 1 acre
- Contact Mix (milfoil, nuisance natives) = 5 acres
- Copper @ starry rates = 6.5 acres
- Chelated Copper Liquid (wild celery) = 1.5 acres

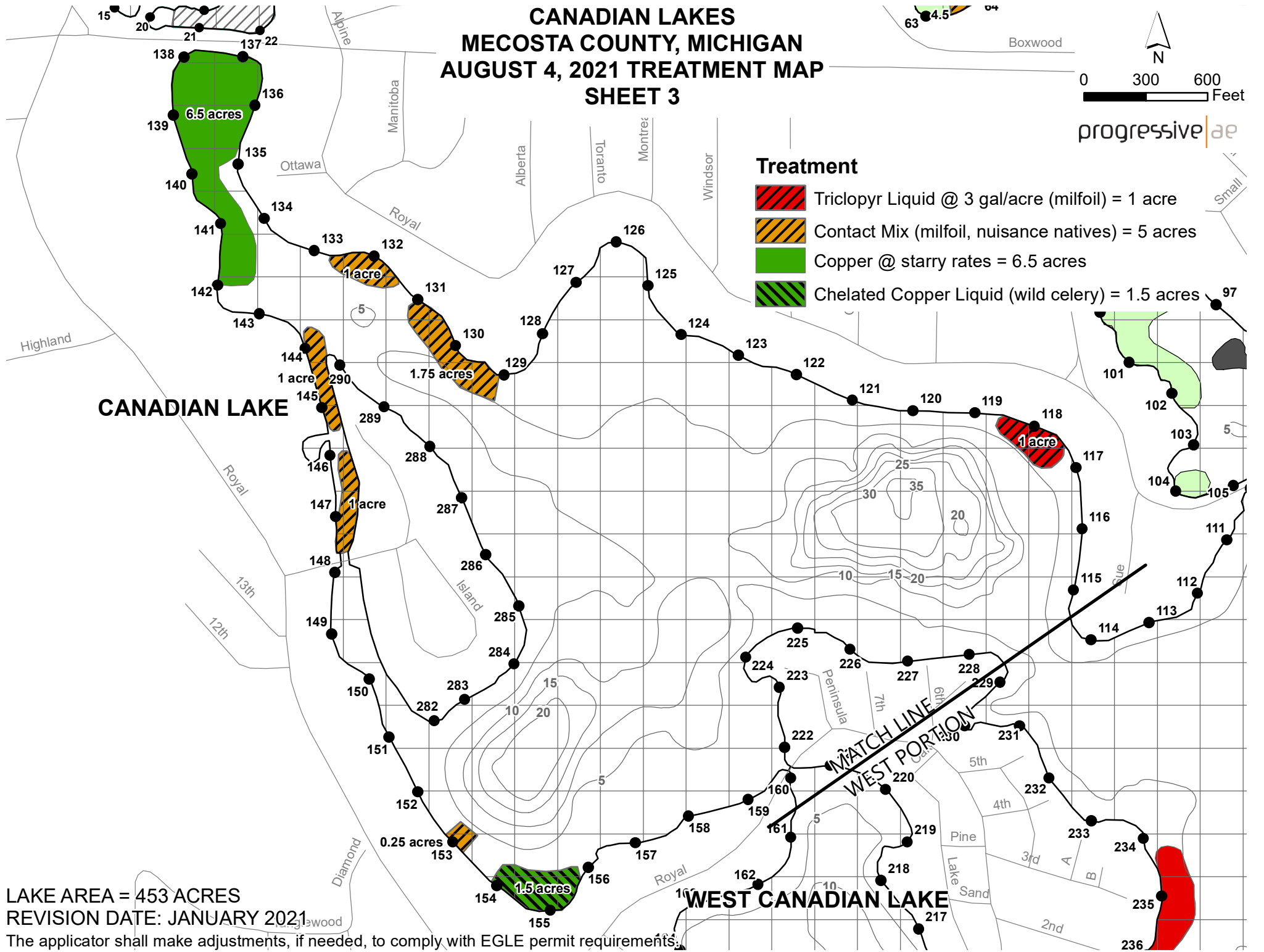

LAKE AREA = 453 ACRES  
REVISION DATE: JANUARY 2021

The applicator shall make adjustments, if needed, to comply with EGLE permit requirements.

# CANADIAN LAKES MECOSTA COUNTY, MICHIGAN AUGUST 4, 2021 TREATMENT MAP SHEET 4

## Treatment

- Triclopyr Dry @ 160 lbs/acre (milfoil) = 0.25 acres
- Triclopyr Liquid @ 3 gal/acre (milfoil) = 2 acres
- Contact Mix (milfoil, nuisance natives) = 3.25 acres
- Algae treatment = 0.5 acres

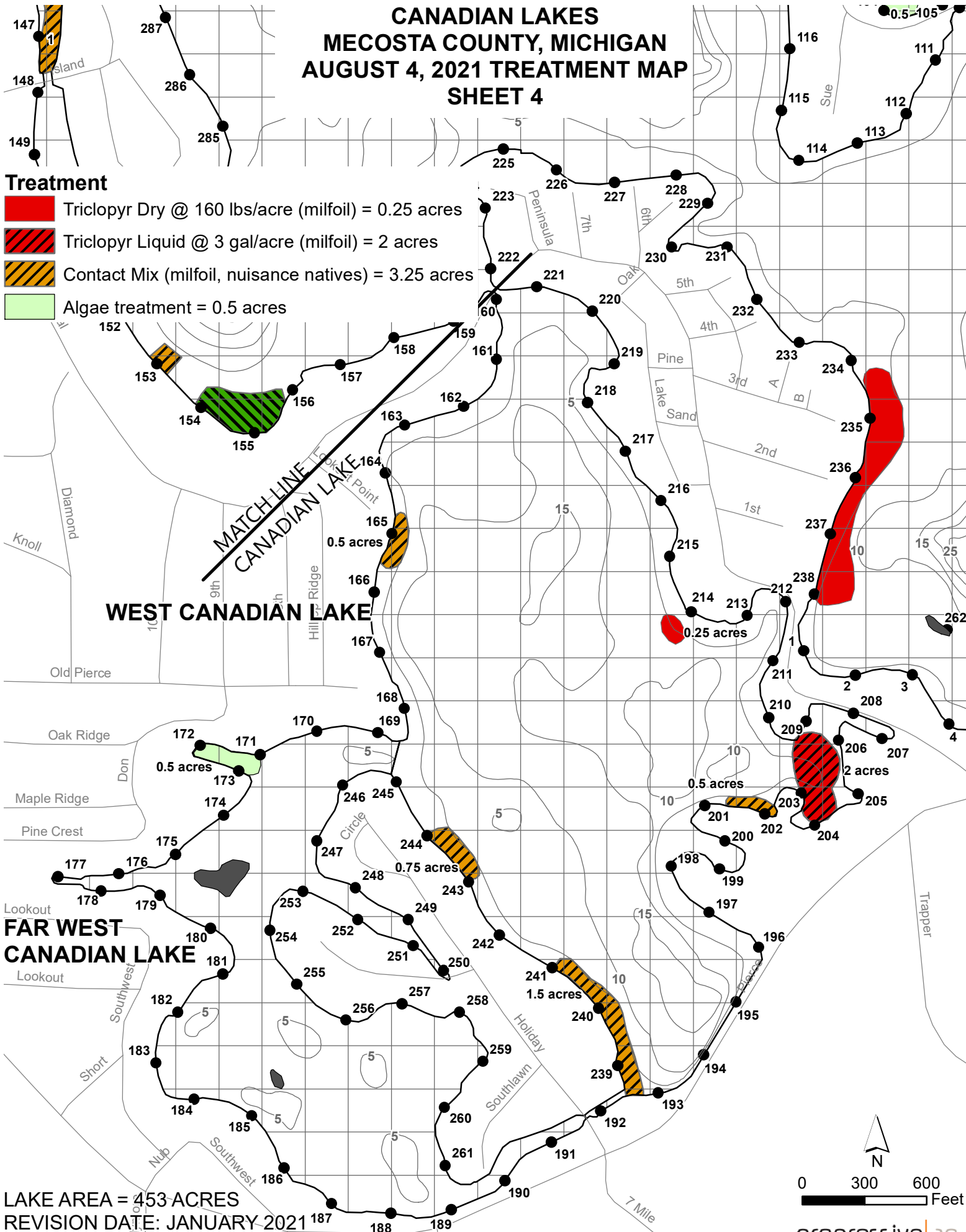

LAKE AREA = 453 ACRES

REVISION DATE: JANUARY 2021

The applicator shall make adjustments, if needed, to comply with EGLE permit requirements.

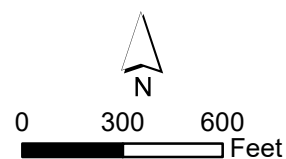

progressive|ae

# LAKE LAURA AND SUNSET LAKE MECOSTA COUNTY, MICHIGAN AUGUST 3, 2021 TREATMENT MAP

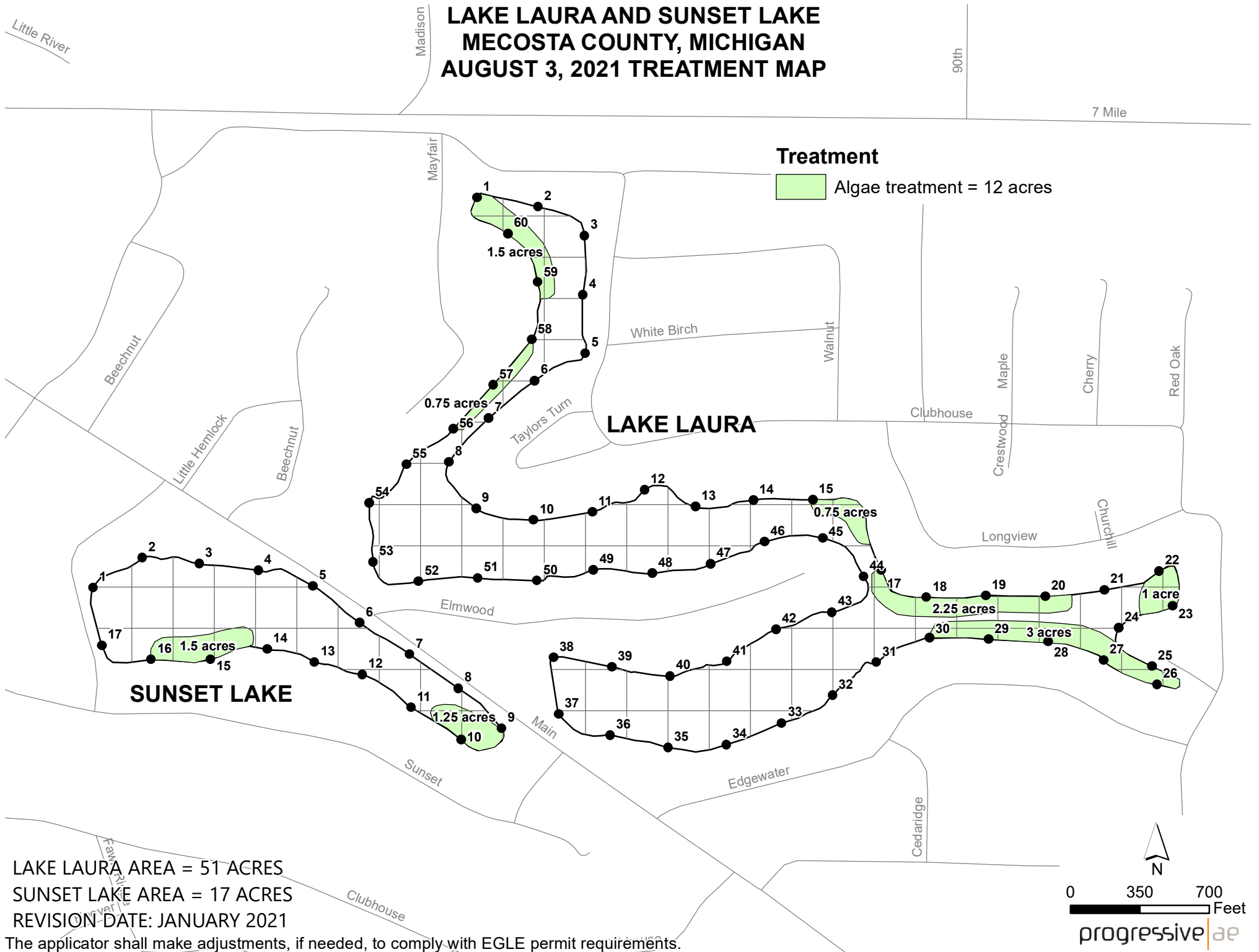



LAKE LAURA AREA = 51 ACRES  
 SUNSET LAKE AREA = 17 ACRES  
 REVISION DATE: JANUARY 2021

The applicator shall make adjustments, if needed, to comply with EGLE permit requirements.

**LAKE OF THE CLOUDS  
MECOSTA COUNTY, MICHIGAN  
AUGUST 3, 2021 TREATMENT MAP**

 = 1 ACRE

**Treatment**

-  2,4-D Amine @ 160 lbs/acre (milfoil) = 2.5 acres
-  Diquat @ 1.5 gal/acre (milfoil) = 1.5 acres
-  Algae treatment = 1 acre

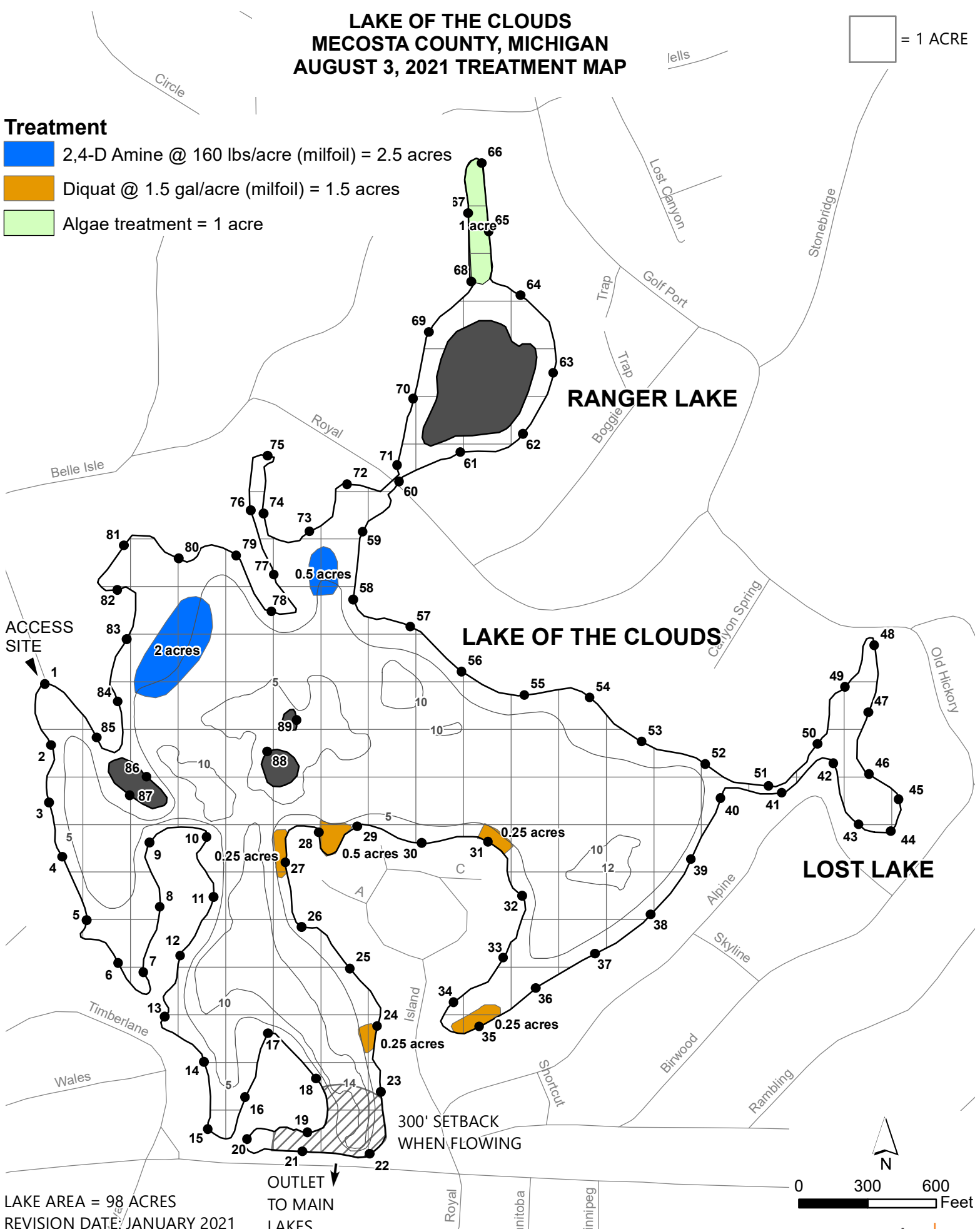

ACCESS SITE

300' SETBACK  
WHEN FLOWING

OUTLET  
TO MAIN  
LAKES

LAKE AREA = 98 ACRES  
REVISION DATE: JANUARY 2021

The applicator shall make adjustments, if needed, to comply with EGLE permit requirements.

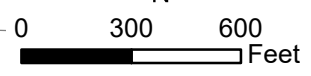

progressive|ae